

# MOUNTING INSTRUCTIONS

# STD

VER.03-2017EN

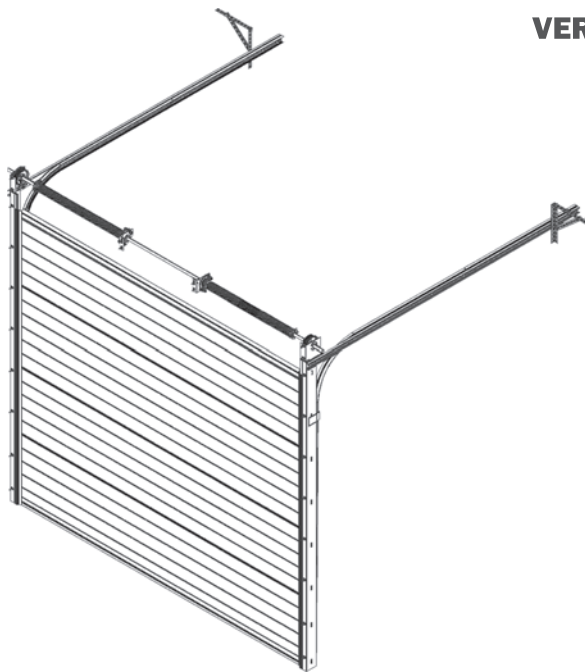



Company Kružík s.r.o. has developed the complete set of track system for sectional doors of residential buildings. It was specially developed

for the situations with a headroom of min. 350mm.

The set has got following characteristics:

- Springs in the front, behind the headroom
- Inner wire guide
- Size for installation: 100mm side room, 350mm headroom

In this handbook we are mentioning the instructions for the correct installation of our track system. This handbook is dedicated to be used by experienced and qualified technicians and it's not advisable for handymen or for using by unschooled personal.

In this handbook we are mentioning the instructions for the correct installation of our track system. The supplier answers for the installation of the whole door. This handbook is dedicated to be used by experienced and qualified technicians and it's not advisable for handymen or for using by unschooled personal.

#### The standard track system set is composed by following parts:

- A set of rails (vertical and horizontal)
- B necessary standard parts/ basic material for montage
- C fittings (hinges, wheels, etc.) from selected material
- D set of wires
- E torsion bar
- F torsion spring

*Notice: Parts (bolts, etc.) required for mounting the tracks to the wall or for its hanging to the side wall or ceiling are not included.*

#### Optional equipment

- G connecting/hanging profiles of horizontal rail set
- H upper sealing for montage to lintel

We are sure that you will successfully install the track system.

When you will have some questions or you will need to clear up any problem please don't hesitate to contact Kružík Ltd.

#### ATTENTION!

- ! **This handbook describes just the installation of the track system parts and it's necessary to complete it with instructions for the montage of any optional parts.**
- ! **Carefully read this handbook before beginning the installation.**
- ! **Some of the parts might be sharp or might have burrs.**  
**We recommend using protective gloves.**
- ! **All supplied parts are engineered for using with up-and-over doors.**
- ! **Through the tension the springs can put out heavy forces. Work carefully. Use proper equipment. Respect that you stay in a stationary position.**
- ! **By the installation ensure enough light. Remove obstructions and dirtiness. Ensure that there is no one to assist except the mounters on the installation place.**  
**Other persons (children) can be in the way through the installation and they could threaten themselves.**

#### Equipment necessary for correct and fast installation

Electro-tools	tools	air level
Drilling machine	o-keys 10, 13, 14, 15, 17mm	yardstick
Impact drilling machine	gola set 10, 13, 17	pencil
Aku-drilling machine	set of imbus keys	2× bar for springs tensing
grinder	nut 10, 13mm + prolonged	rope
	bits adapter	2 blocks, appr.20 and 40mm
	combination pliers, gas pliers	high
	hammer	clips

#### The construction conditions on the site are for sectional private and industrial doors installation and their further flawless operation essential!

- surface flatness
- for the sectional door installation they have to be even (side room, headroom, floor). Side room and headroom have to run in one line. Maximal allowed flatness variations are +/-2mm.
- masonry base for installation has to be solid and dry. In the mounting area is no electric wiring within the walls allowed.
- each larger unevenness of the mounting base, can have a negative influence on the proper door operation. Use plugs with 12mm diameter to fix the sectional doors in the masonry wall.

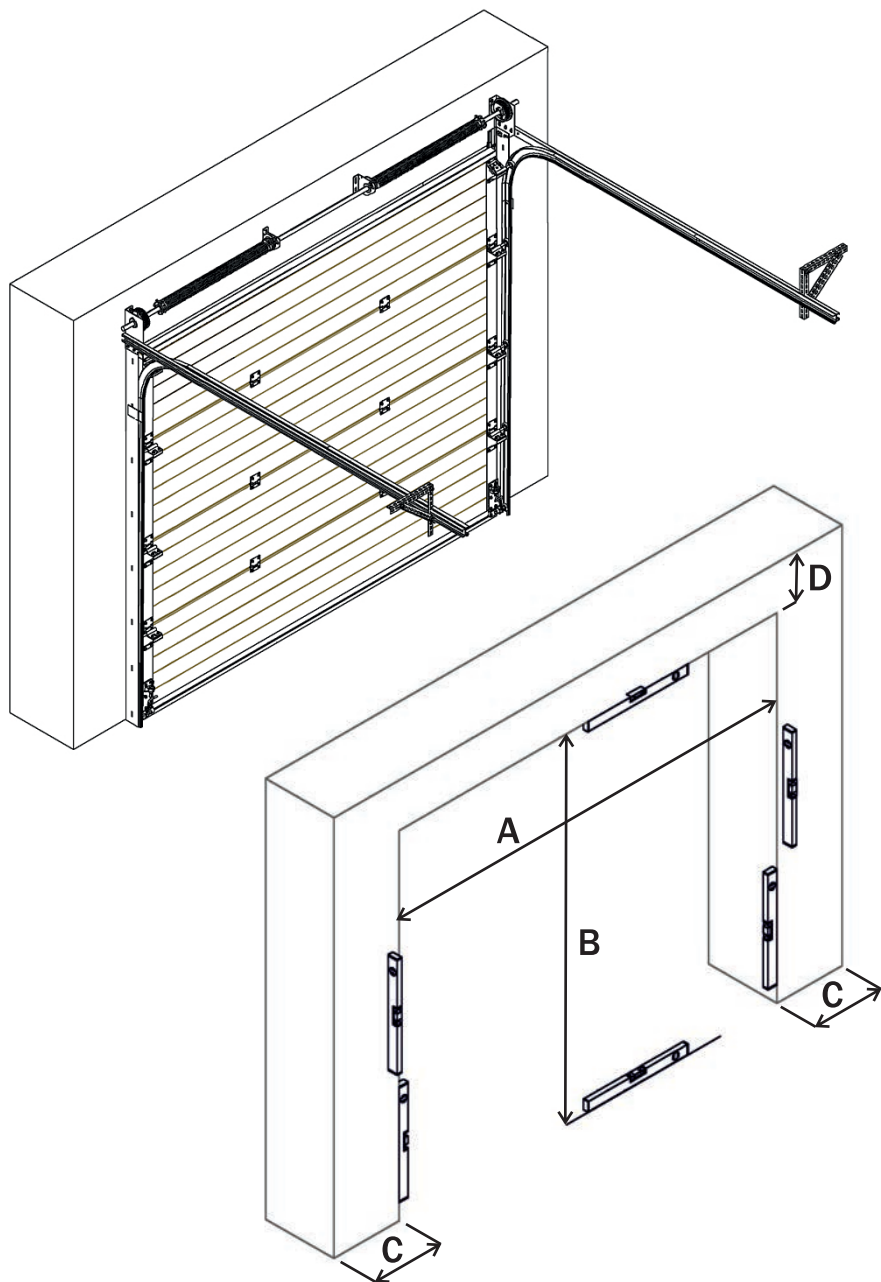

Installation of 25734 side hinges, 25733 intermediate hinges.

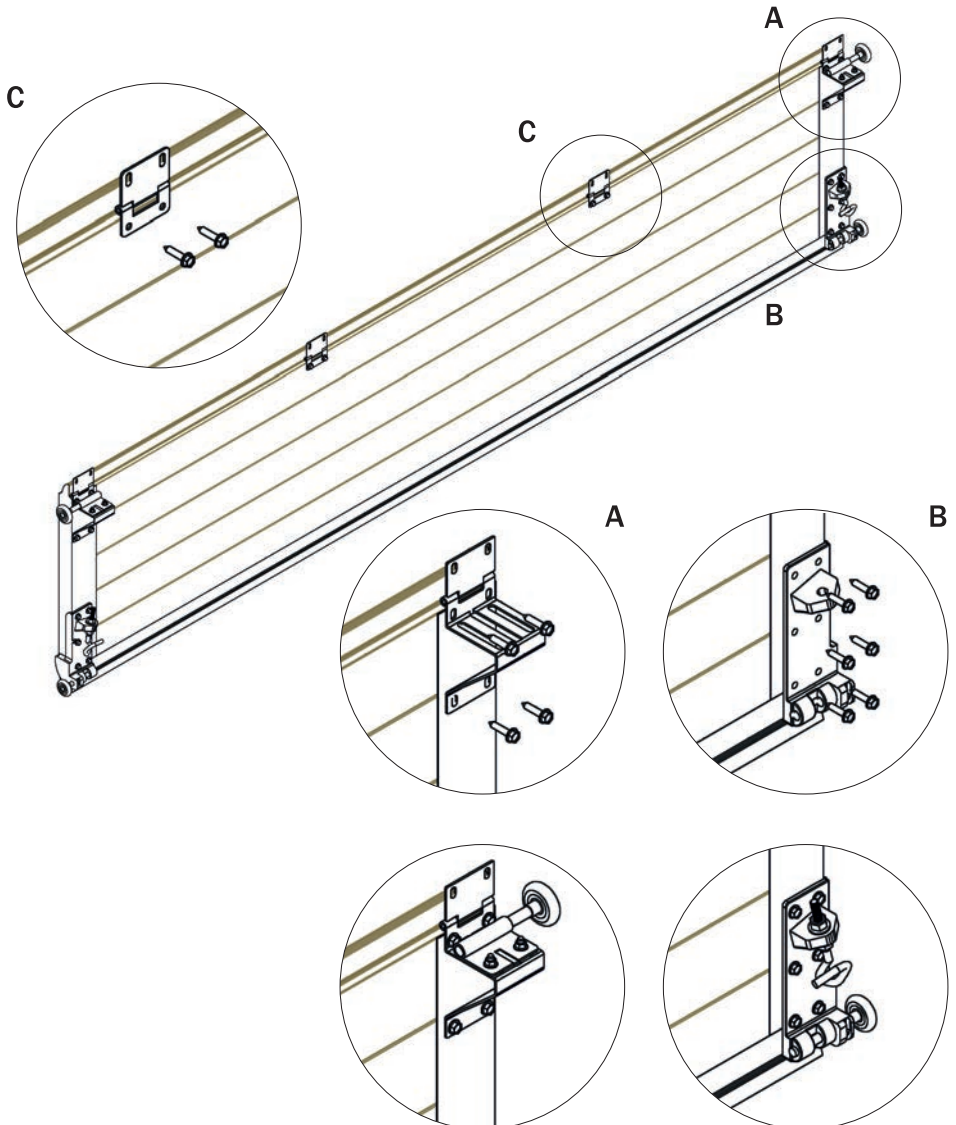

Installation of 450CZ+10 side hinges, 450HZ+10 intermediate hinges.

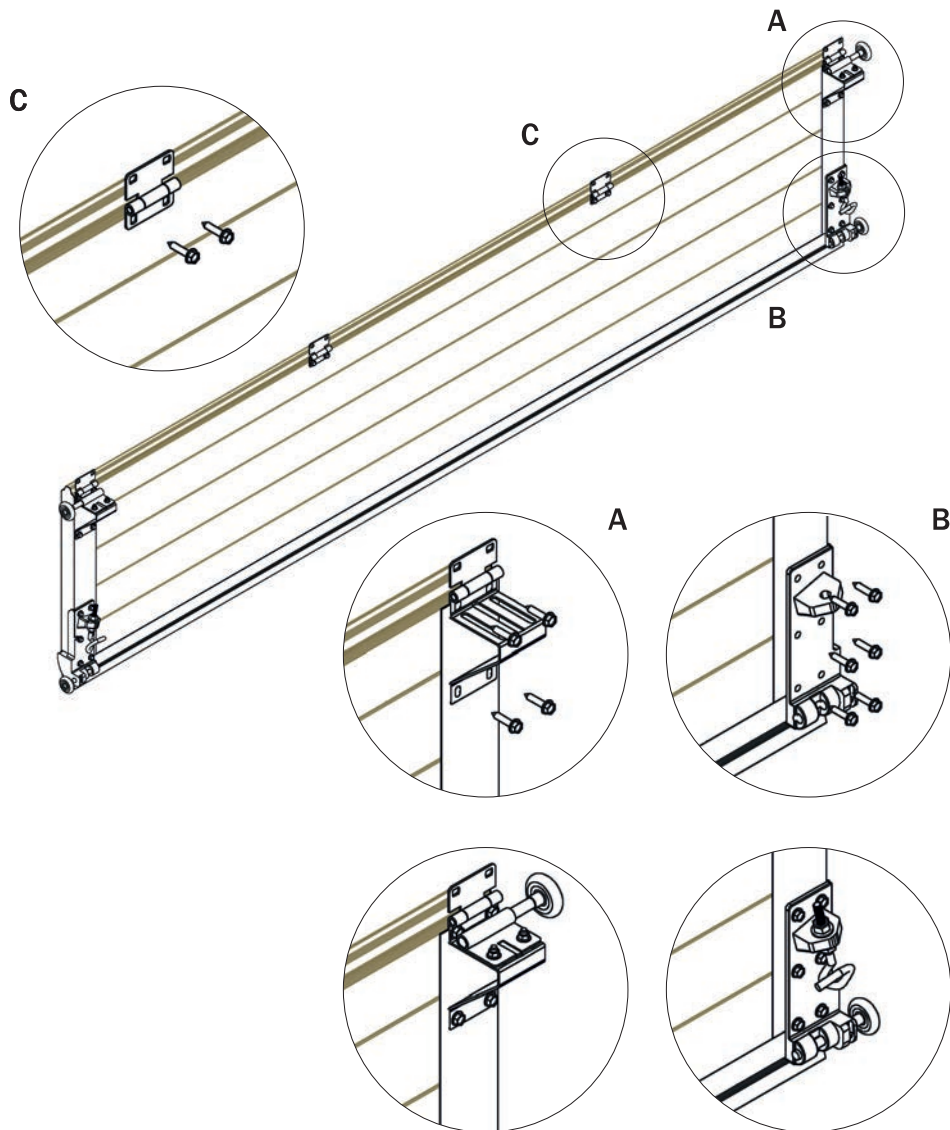

The section is to be positioned into the opening so that it laps over 25mm on each side. The rolls are to be put into side and bottom hinges. The section in the opening has to be balanced by an air level.

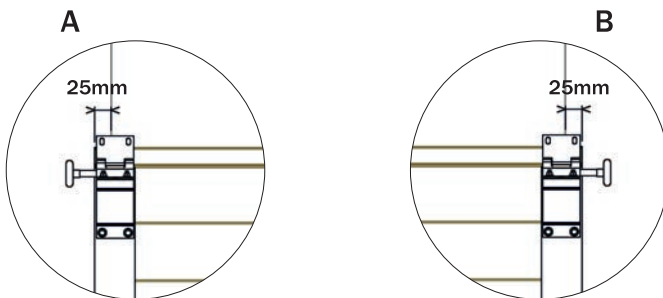
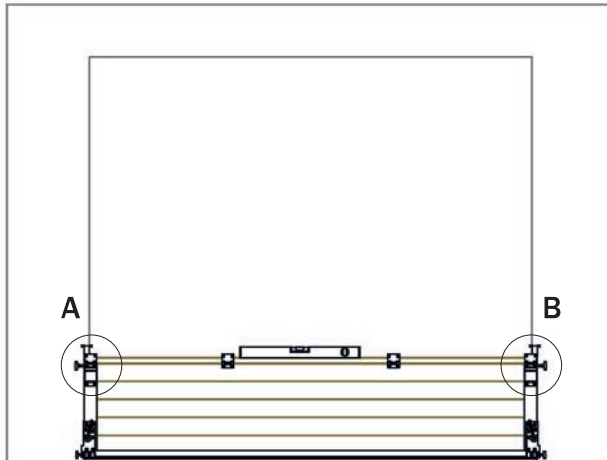

The rolls of bottom section are to be put into vertical rail. The free motion between the bottom roll and the vertical rail has to be at least 1mm, max. 3mm. The rail is to be balanced by an air level and marked.

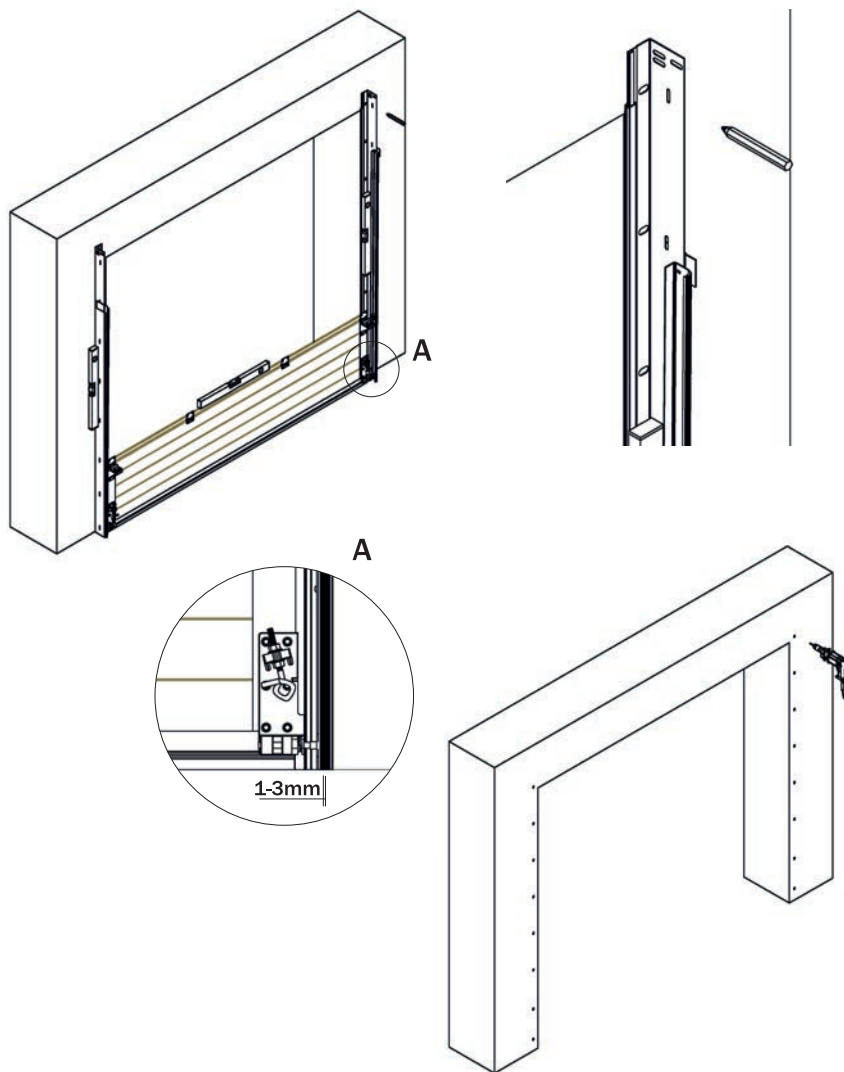

The marked openings will be drilled by a 12mm drill, the wall plugs will come inside.

We insert the section and the vertical rail into the door opening. The vertical rails will be balanced by an air level and fixed.

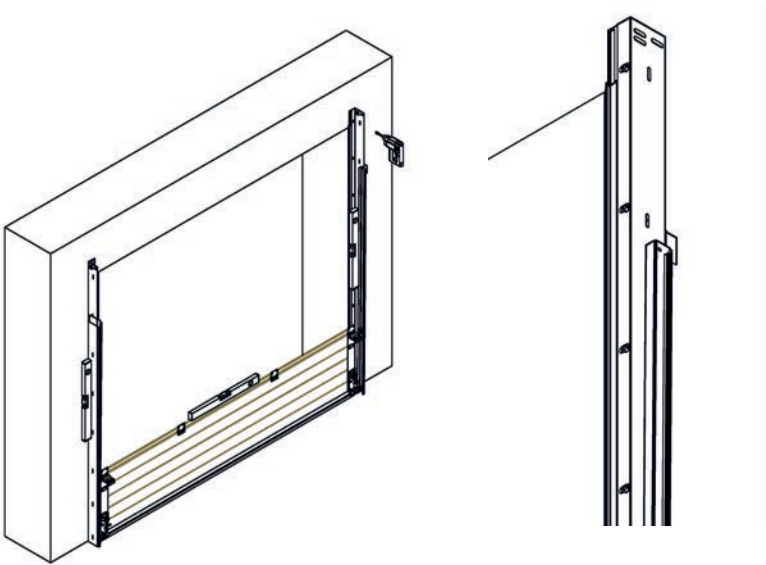

Fix the outer bearing console with bolts to the vertical rail, then to the walling.

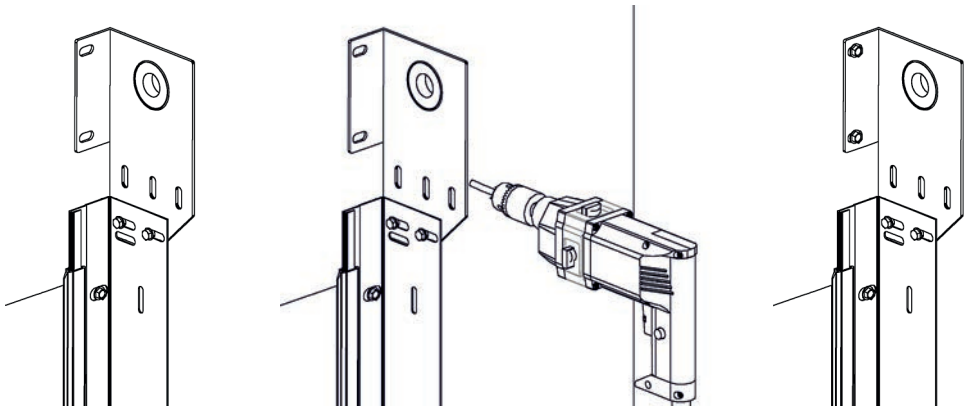

First bolt up the horizontal rail using M6 bolts to the vertical rail in such way to fit optimal the curve on the vertical J-profile. Align the horizontal rails with an air level and bolt up using M8 bolts.

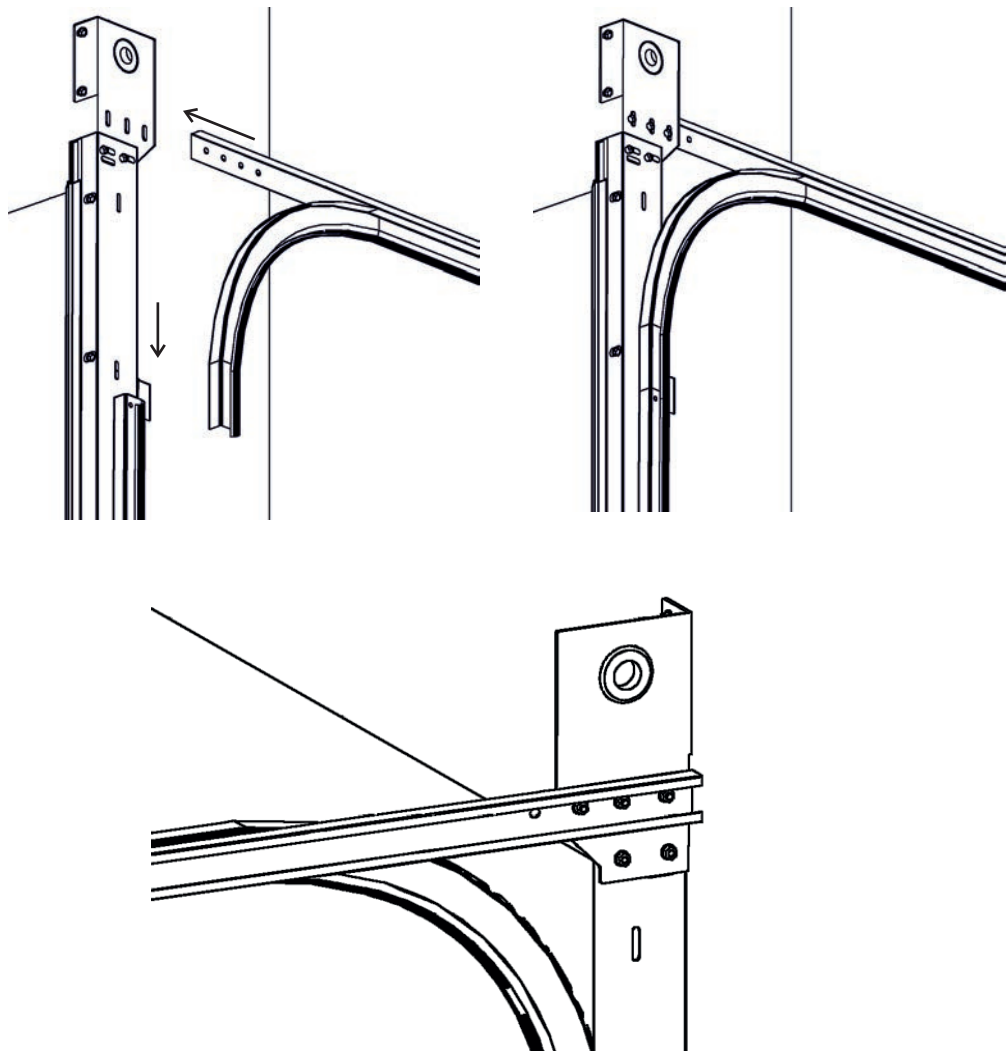

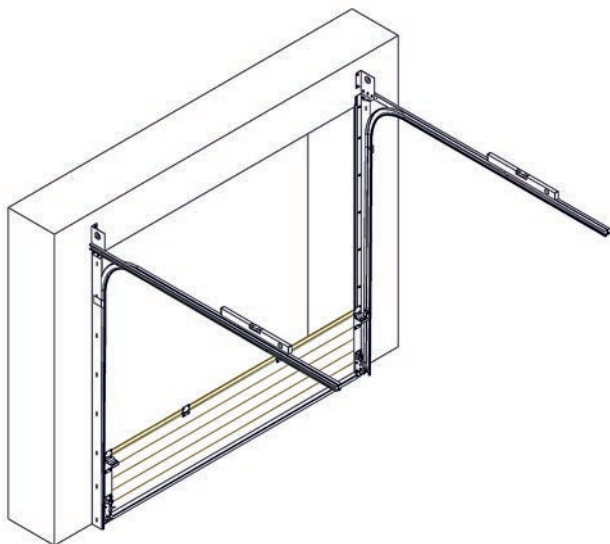

We slip the spring break device over the torsion bar.

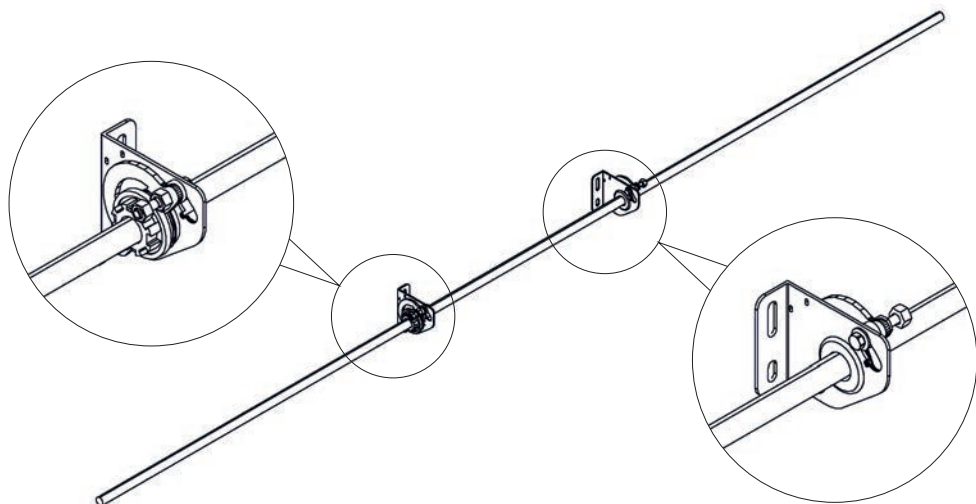

We screw up springs to spring break device.

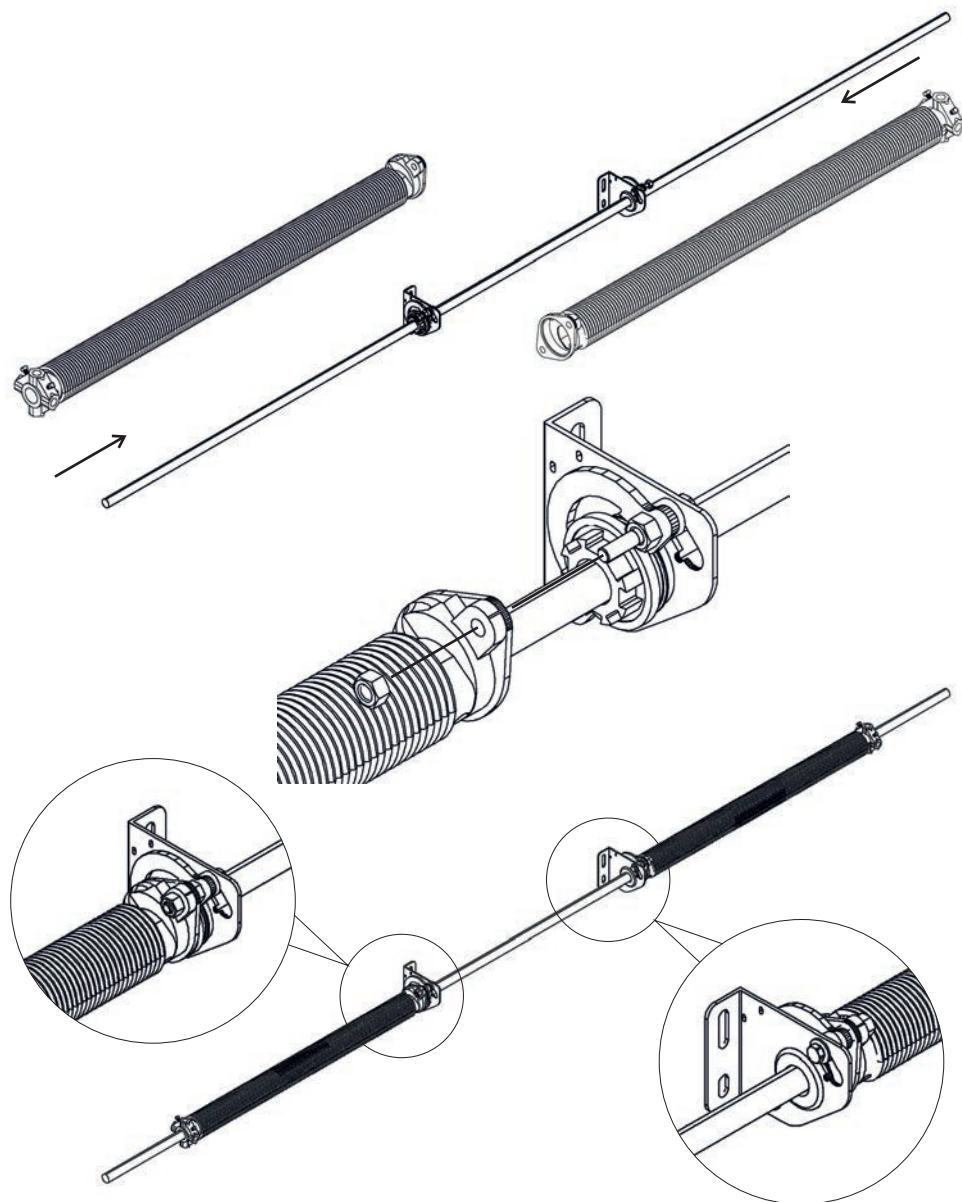

Slip the winding drums over the torsion bar.

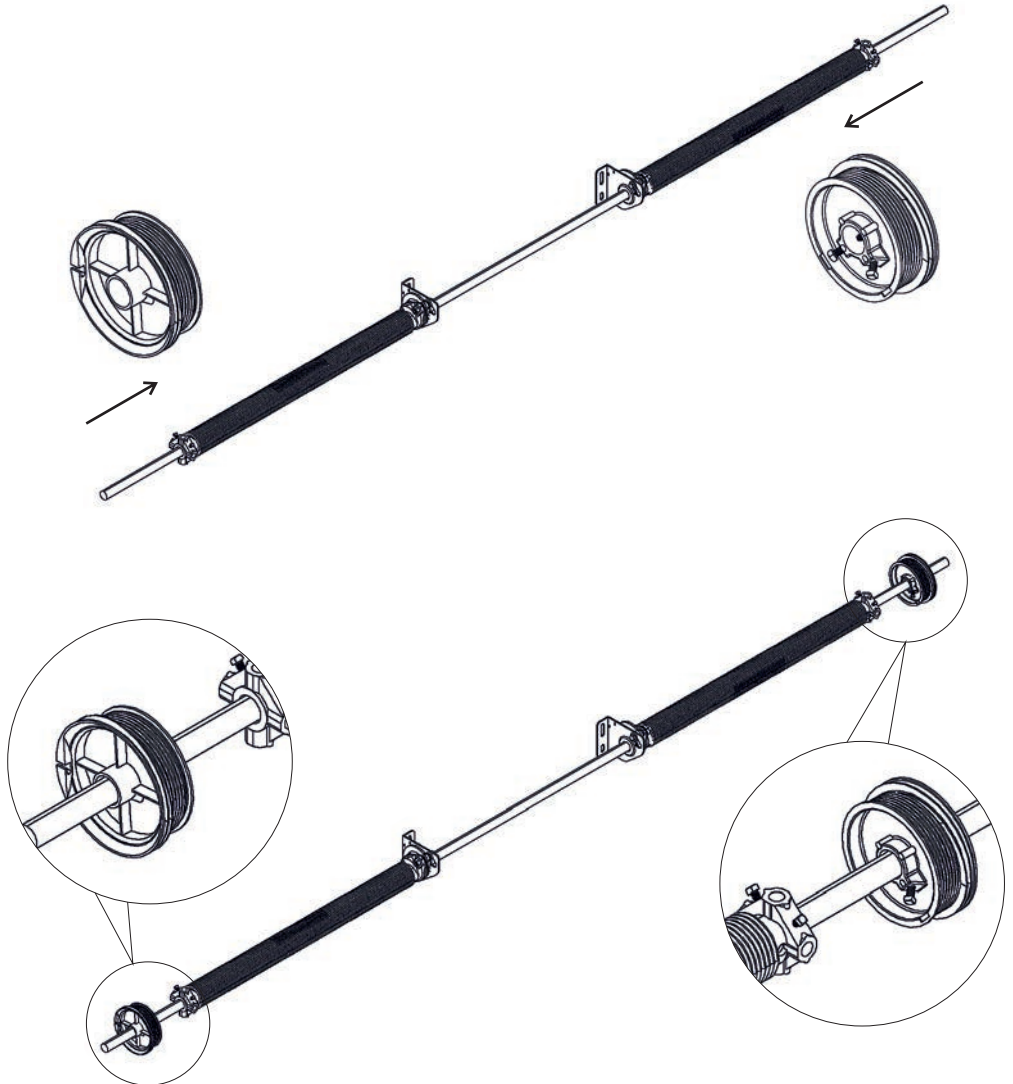

Insert the torsion system into the outer consoles on the horizontal rails. Mark the position of the spring break devices, drill 12mm holes and apply wall plugs. Fix the spring break devices to the masonry.

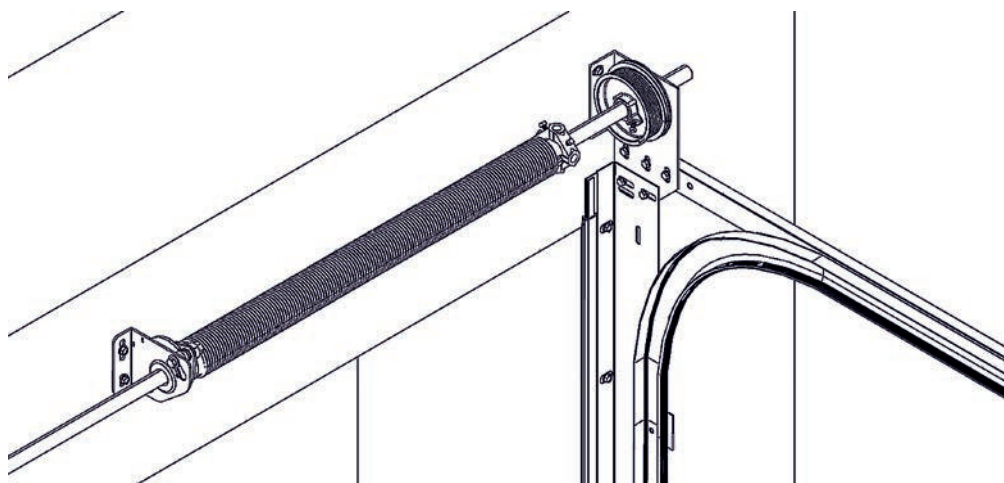
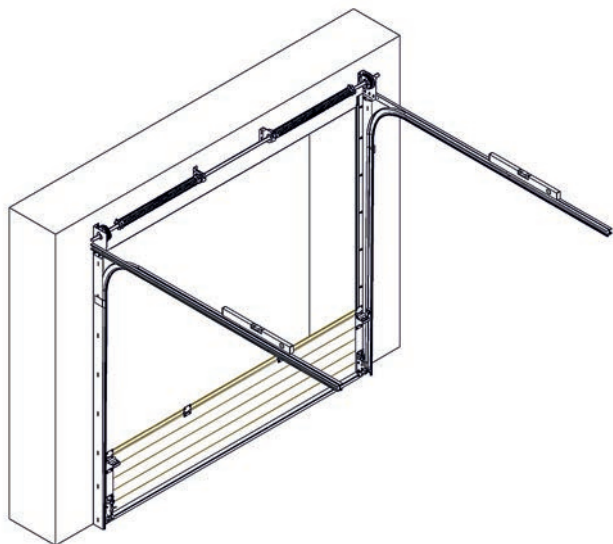

Put the cable grit on the adjustment hook of the bottom hinge. The cable gets out behind the bottom hinge and its other end gets fixed to the winding drum.

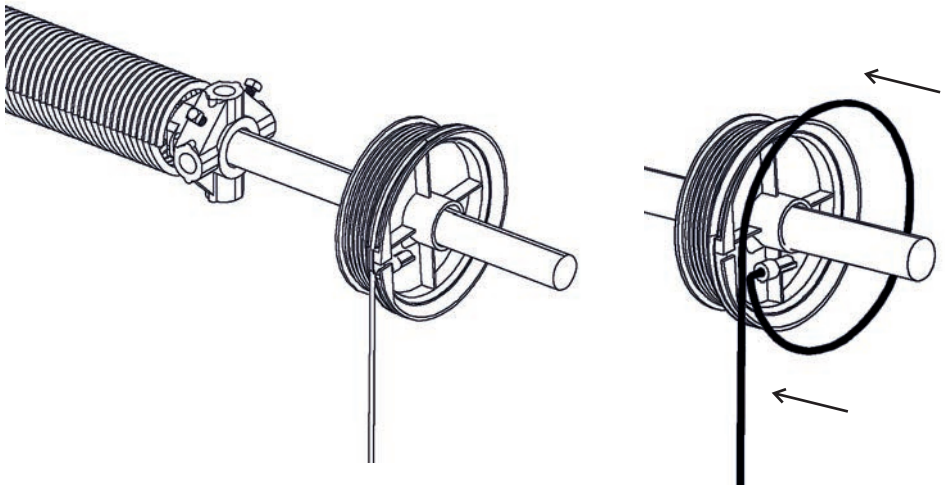
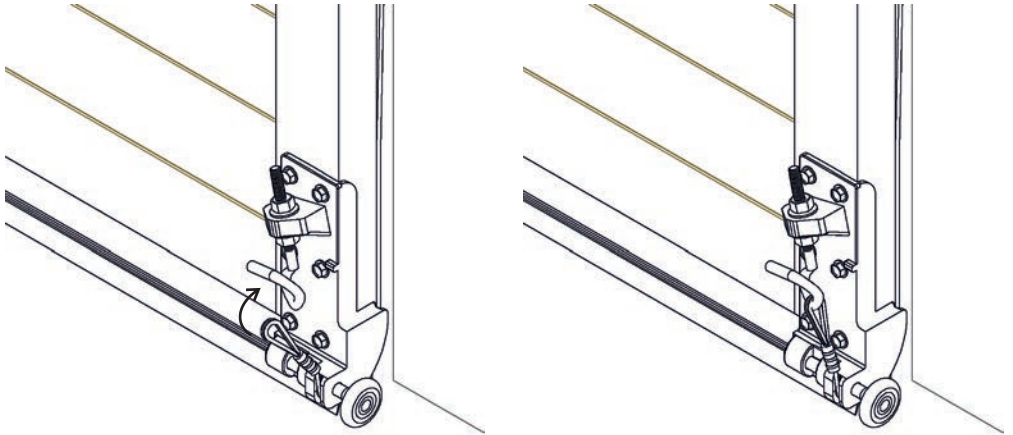

Turn the drum until the lifting cable is tight. Align the winding drum with the bar, so that the lifting cable can freely reel up. Then secure the winding drum on the bar by bolts (torsion moment 10Nm). When the door is absolutely equilibrated, both cables are tightened equally.

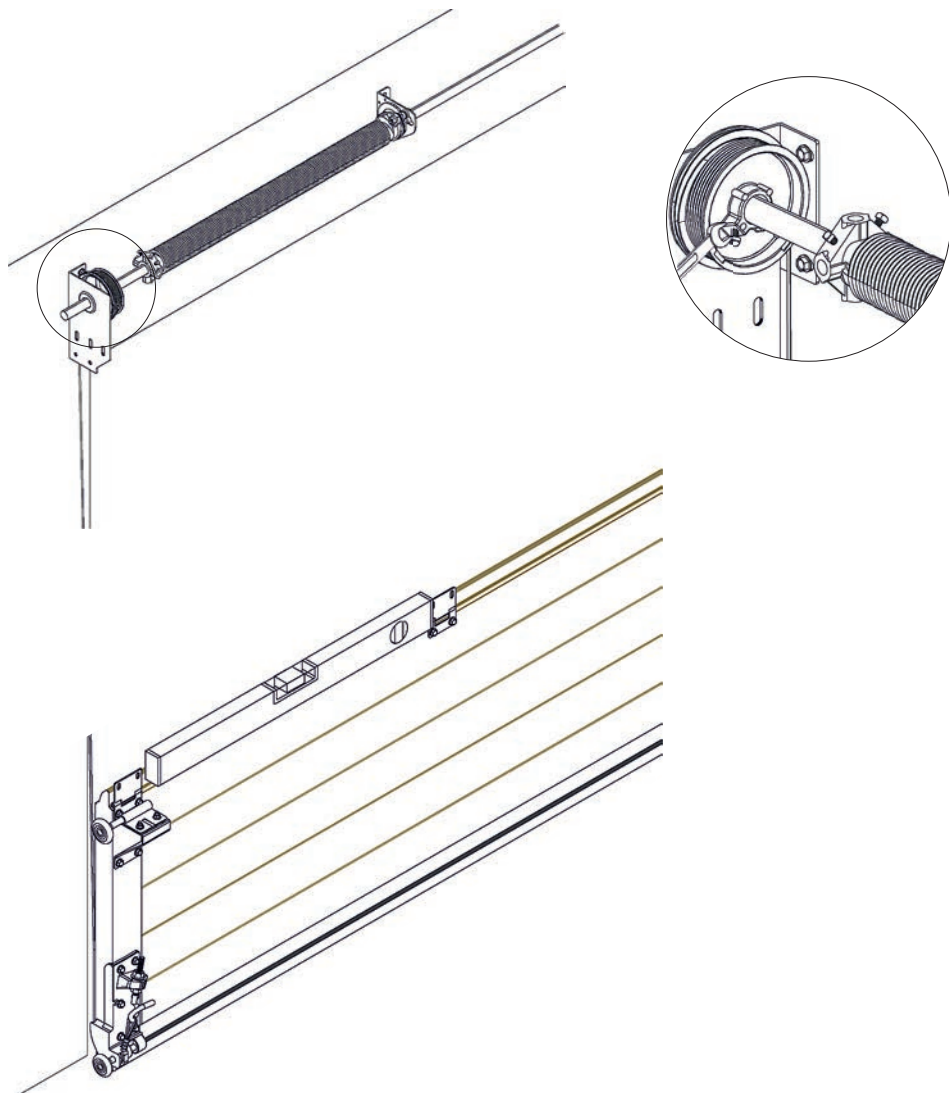

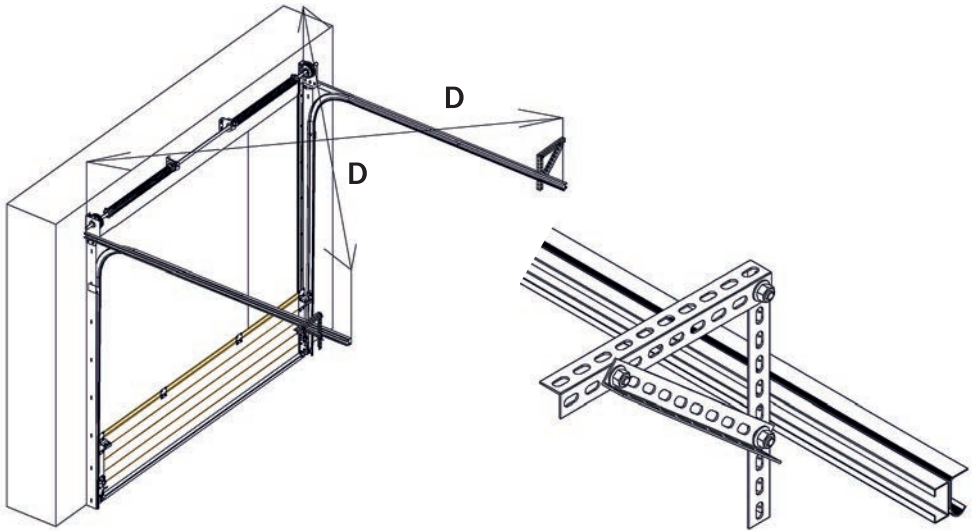

With a perforated mounting profile fix the horizontal rails to the ceiling. Then inspect the diagonals, in case of necessity adjust the horizontal rails so that the diagonals are equal.

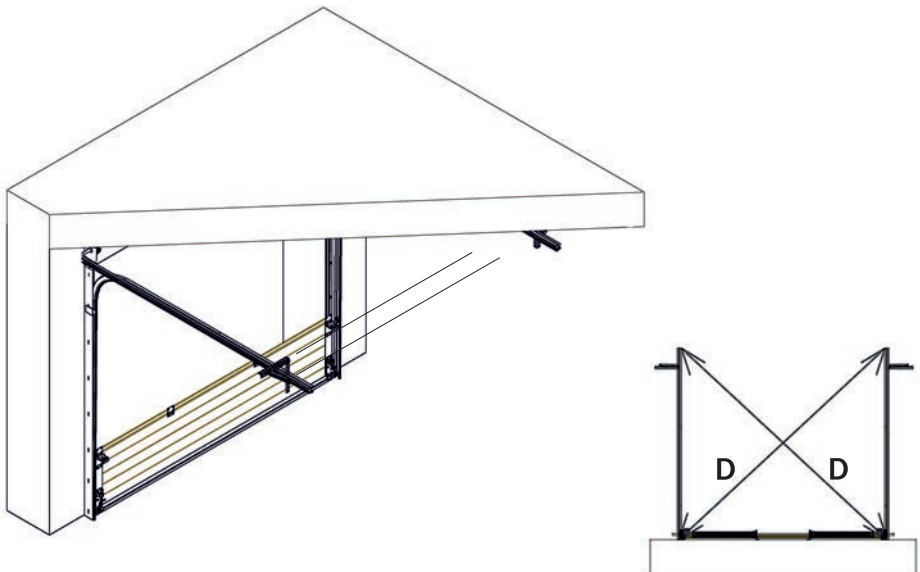

Distance washers should come in between the sections to each hinge, after lifting the doors they will be removed.

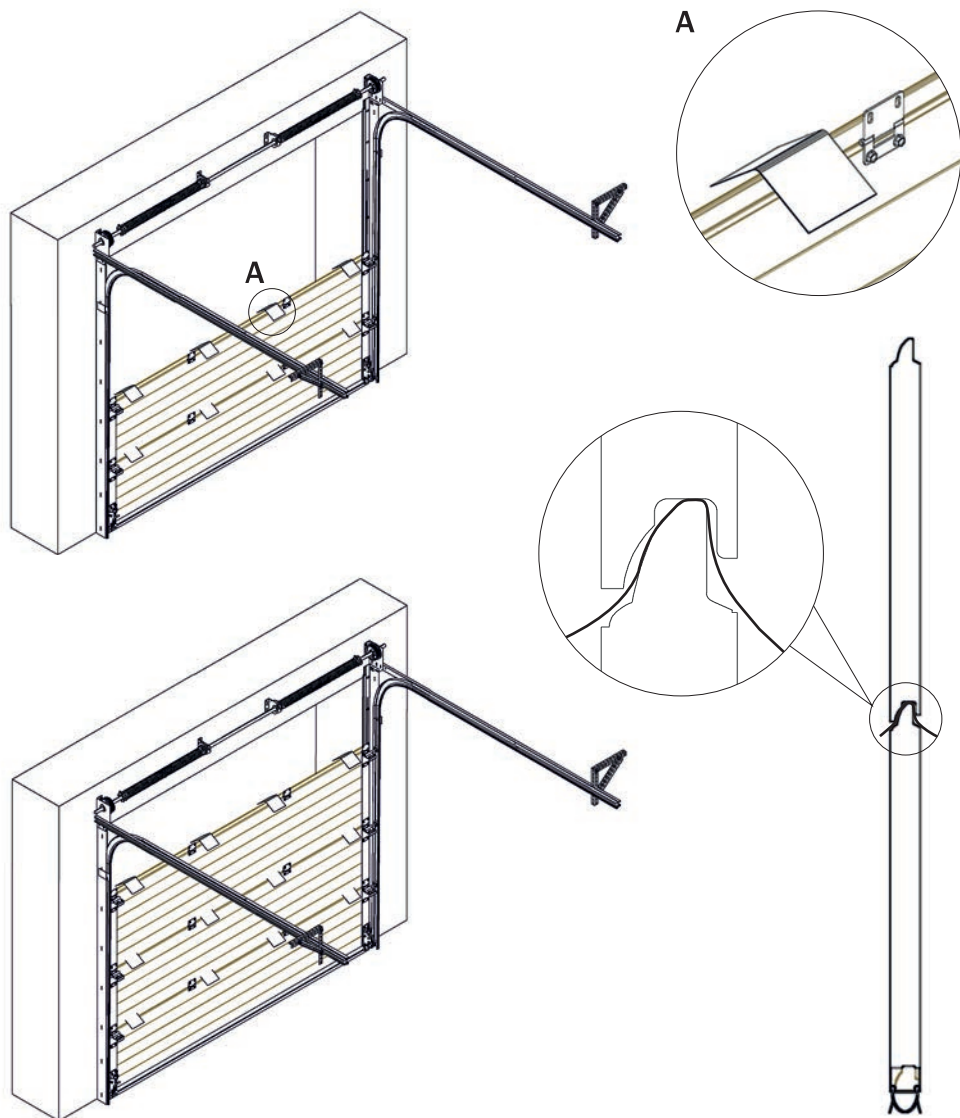

The sections 2,3 .... and top section come into the opening successively. Fix the upper hinge on the top section, so that the section sufficiently seals.

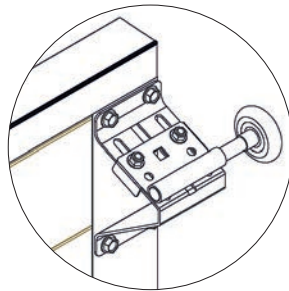
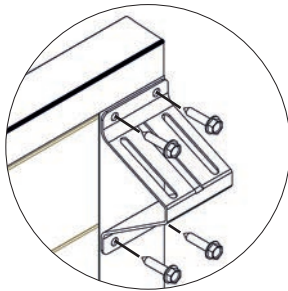
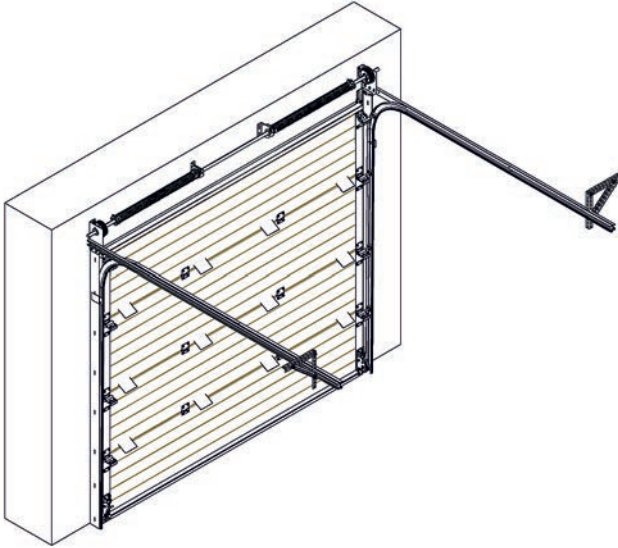

The side hinge will be adjusted, so that between the section and the side sealing there is a free motion of 1mm. Tightening the top section can be made by adjusting the upper hinge upwards or downwards.

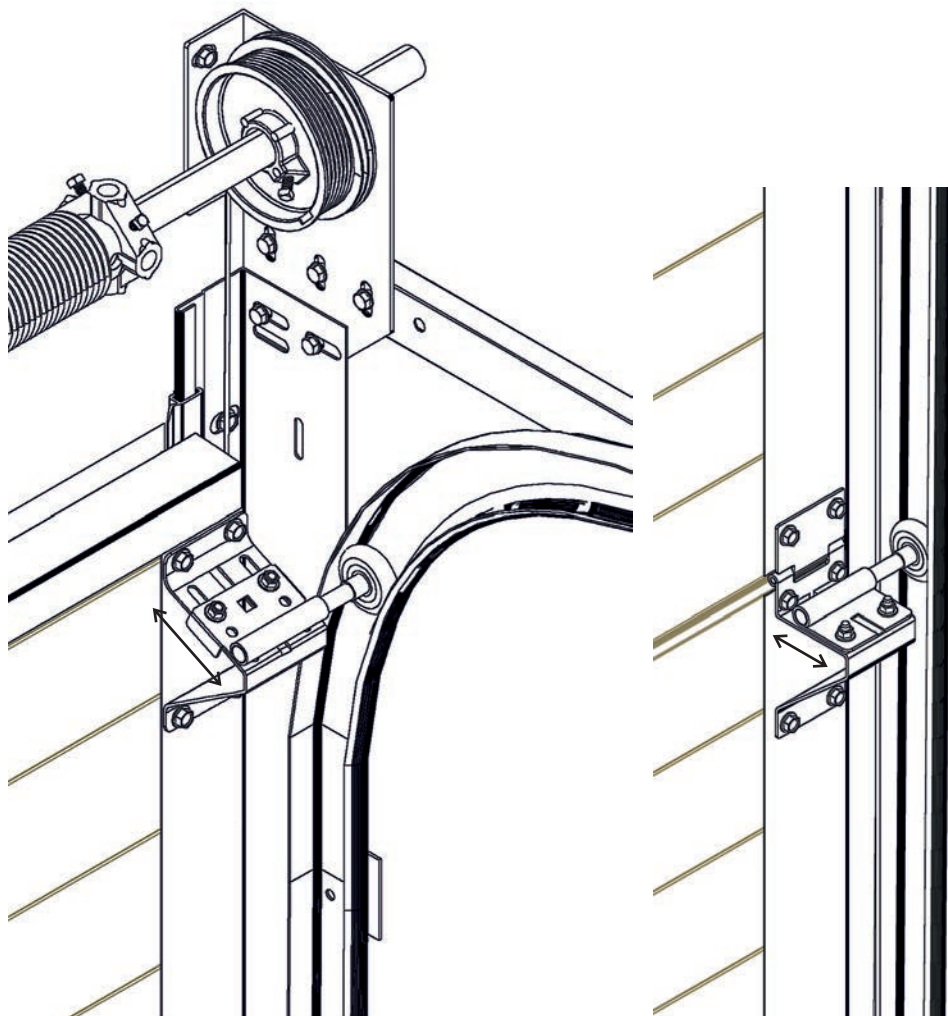

After opening the doors the rubber backstop will be mounted into the horizontal rails.

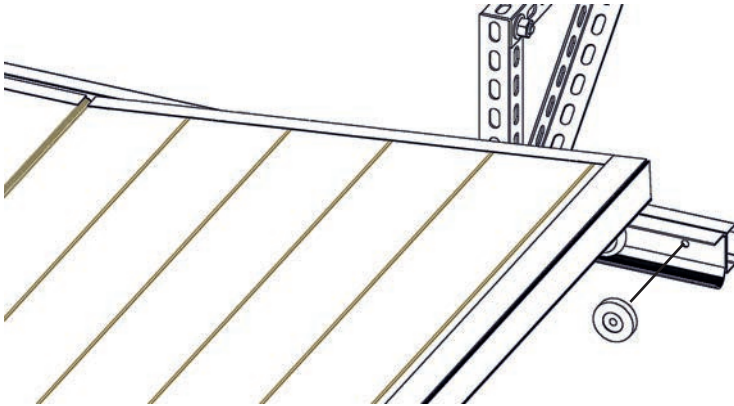

In case of necessity to stabilize the sections into horizontal position, adjust the manipulation hooks in the bottom hinges, after balancing the sections tighten the screws female on the manipulation hook.

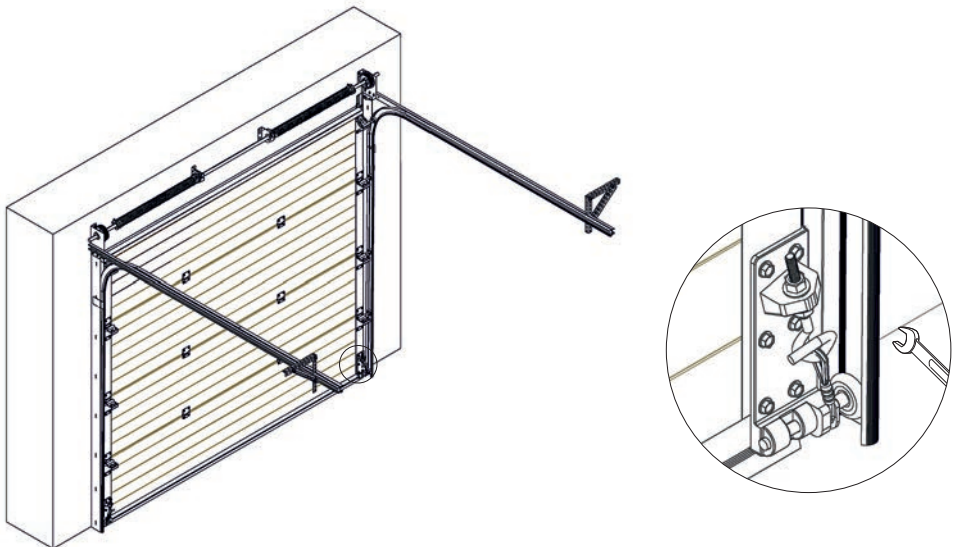

Secure the torsion bar against spinning, tighten the first spring with a tension rod with the required number of turns, then secure by bolts. Repeat the procedure for the second spring.

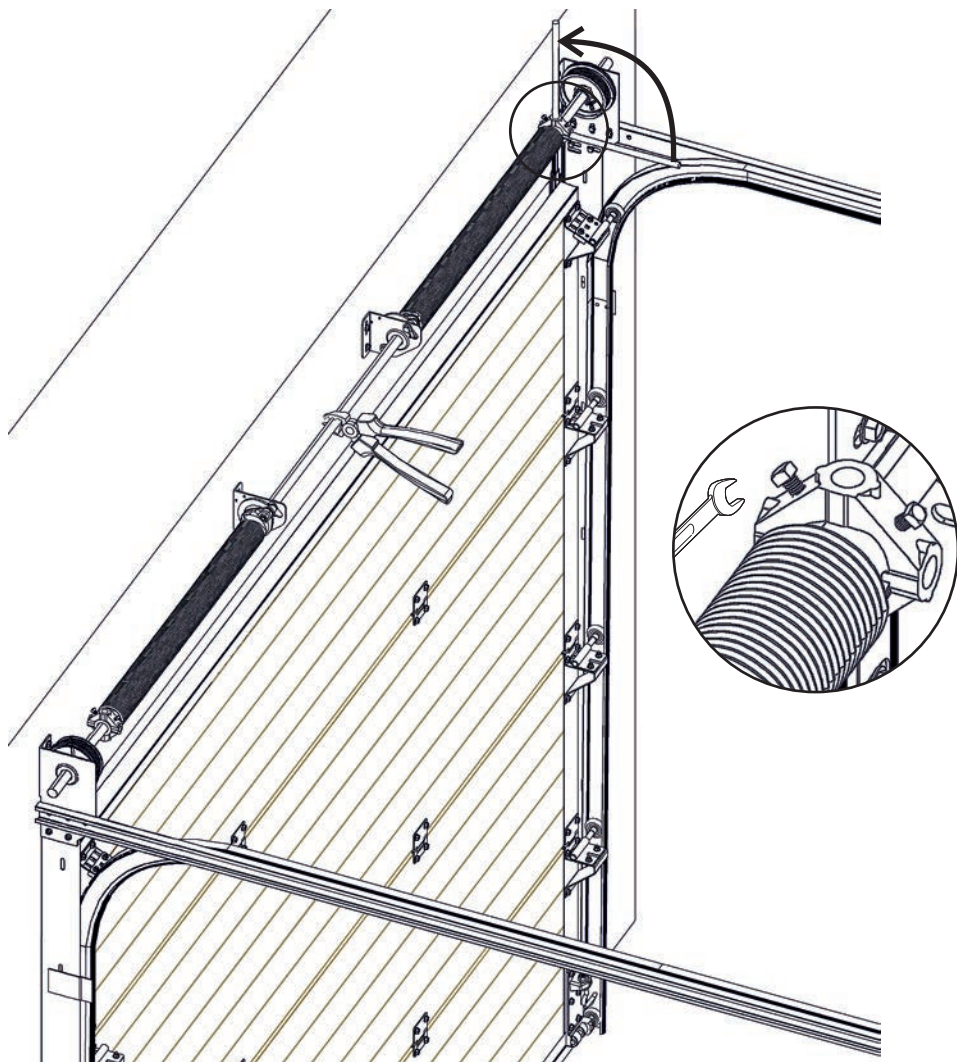

After springs setup test the doors functionality. It has to run up and down easily.

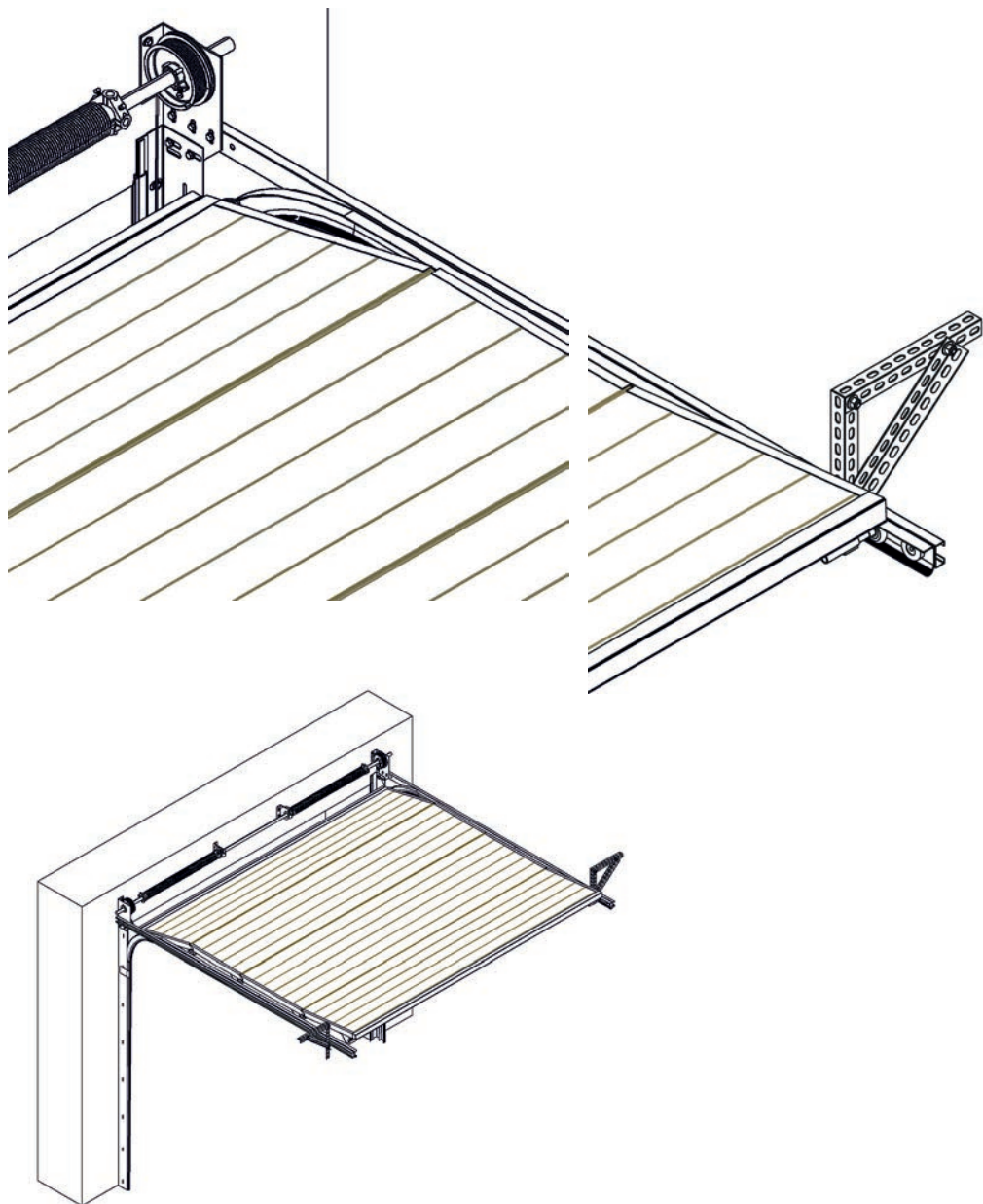

### Montage of omega profile armouring

Rivet the omega profile to max. 300mm to the top section. Screw the top part of omega profile to the bottom and central section. The bottom section rivet max to 300mm.

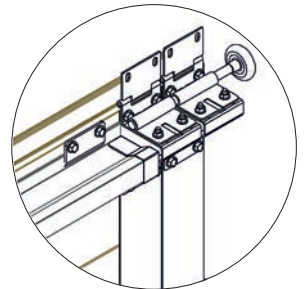
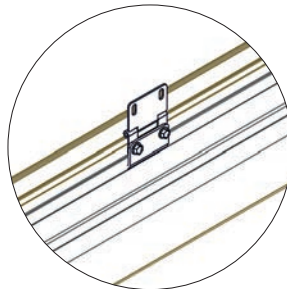
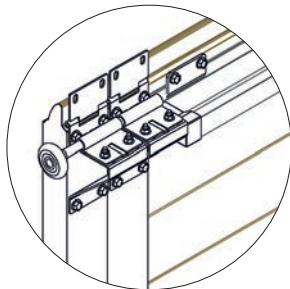
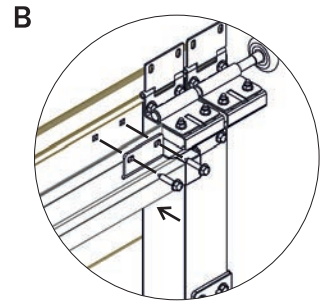
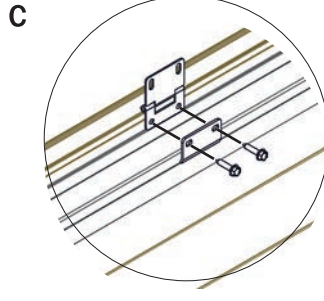
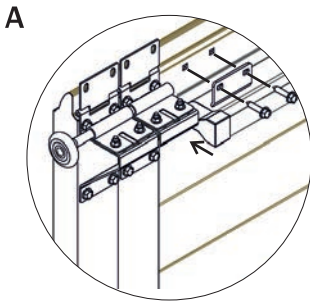
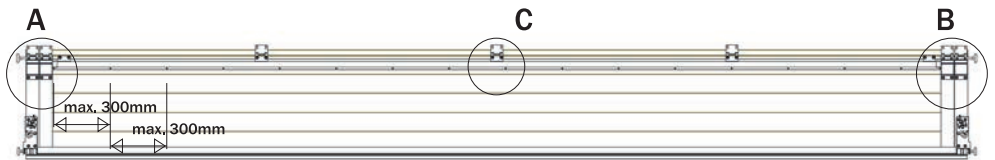
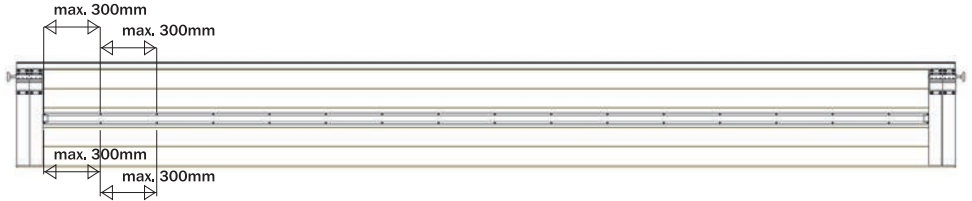

## **Instructions for demounting**

**The sectional door has to be closed before demounting!!!**

**Don't do demounting works until you don't cushion the torsion springs!!!**

### **1) Torsion bars cushioning**

First put the tension rod into the spring head and then disengage release the ensured screw on the torsion spring. Cushion the torsion spring and turn the spring head in its power wise until the spring power stops acting. For spring cushioning of garage doors we need two tension rods with a diameter 11,5mm and for industrial doors with a diameter 16mm.

### **2) Panel demounting**

After the spring cushioning begin to demount the top, middle and side hinges. Begin to demount always from the top panel. After demounting the hinges on the panel remove it immediately. Repeat this procedure for all panels. Unscrew the winding wire by the lower panel hinge and also remove this section.

### **3) Demounting of torsion springs, drums and torsion bars**

Disengage the ensured screws on the drums and the ratchet-wheel of spring break protection. Then unscrew the torsion springs from the spring break protections. In case of two shafts demount the coupler. When using an industrial door opener, it has to be demounted from the torsion shaft before removing the shaft. Move the shaft to one side to pull it out of the spring break device. Then take it down from the console.

### **4) Demounting the console and the spring break device**

After demounting the torsion shaft demount the spring break devices and the consoles from the lintel.

### **5) Demounting the horizontal tracks**

Unscrew the perforated mounting profiles from the ceiling and also the screws connecting the horizontal and the vertical tracks.

### **6) Demounting the vertical tracks**

Unscrew the vertical tracks from the door opening.







**KRUŽÍK® /**

Kroměříž, Veleslavínova 2357, [tel.] 573 336 233, [fax.] 573 343 582  
Praha 10 Hostivař, Herbenova 38, [tel.] 267 710 696, [fax.] 267 710 696  
г. Мукачево 89622, 000, "Кружик Украина", с. Ивановцы, ул. Мира, 3, [тел] +38-050-523-59-69

15062016

[www.kruzik.cz](http://www.kruzik.cz) | [www.kruzik.com](http://www.kruzik.com) | [www.kruzik.com.ua](http://www.kruzik.com.ua) | [www.kruzik.eu](http://www.kruzik.eu)